

Required System Parts:

- (1) Etch Panel Light (w/ Starter Cord) P/N: L-xxxxx-Dy
- (1) Power Supply 12VDC Class 2 60W max.

Accessories (purchased separately): 12V Switches and Dimmers, Extension Cords (see "Accessories" below).

Patents Pending

Installation Instructions

LED Etch Panel Light

5W/ft², 12VDC System

Dimmable

Tresco's LED Etch Panel Lights are designed for backlighting/signage (e.g. snap frames), and cabinet lighting applications – within indoor locations only. To be used with 12VDC Class 2 60W max Power Supplies only. This system is dimmable.

- Always carry panels larger than 24" x 36" vertically.
- Carrying large panels horizontally can bend the frame and damage the panel.

READ ALL INSTRUCTIONS BEFORE INSTALLING SYSTEM.

Before beginning installation, be sure power is turned OFF to light system.

Roughly lay out the lighting system before installation to verify final positioning of all components. Check that the Power Cord will properly reach the 120V power source.

1. First, install the 12VDC Class 2 60W Power Supply (see fig. #1). Keep power off to Power Supply until complete system is installed. Keep Power Supply in an accessible location. A total of 12' (3.66m) linear feet of LED per 60W power supply. 8' (2.44m) max per single run.

NOTE: Use insulated staples or plastic ties to secure ALL cords throughout the installation.

2. Next, install the Etch Panel (with Starter Cord). Mount the Etch Panel as needed (see "Additional Information" section below).
3. Route the Starter Cord (see fig. #2) back to the Power Supply by either running along the mounting surface; or through a hole in the surface. The cord only requires a 3/16" (5mm) hole before the male AMP[®] Connector is attached.

The standard Starter Cord length is 79" (2m). Custom lengths are available.

Also 'Link D' Extension Cords (see fig. #3) may be used to extend the length of the Starter Cord to the Power Supply (see "Accessories" below).

Maximum cord length between Etch Panel and Power Supply should not exceed 15' (4.6m).

4. Attach the male AMP[®] Connector to the Starter Cord (see fig. #4). Then snap together the male AMP Connector to the female AMP Connector of the Power Supply (see fig. #5).

Note: As an option, Tresco[®] DC 60W Power Supplies with Mounting Block are available (P/N: L-DC-ELT60-CON). This allows you to conveniently quick-connect up to (6) AMP connectors directly to the Mounting Block.

5. Final step: check all connections and turn 120V power source onto the Power Supply.

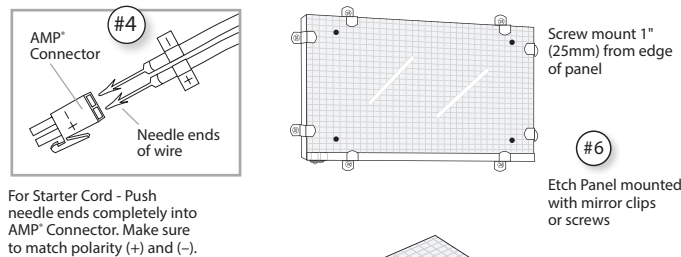

For Starter Cord - Push needle ends completely into AMP[®] Connector. Make sure to match polarity (+) and (-).

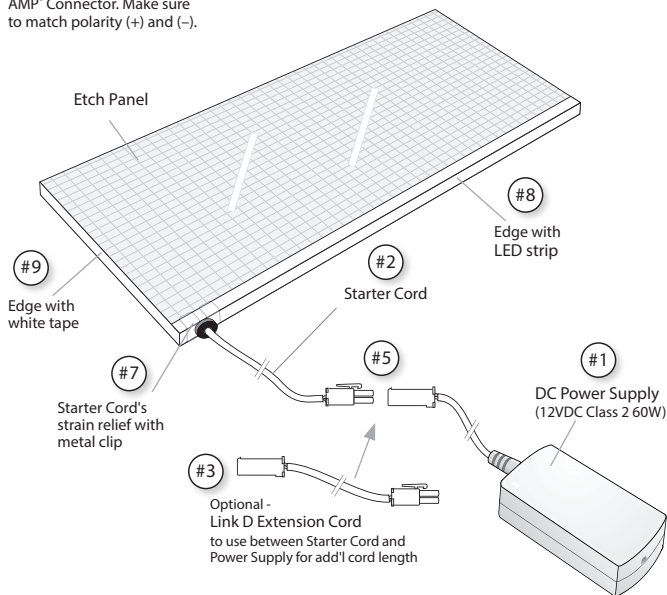

Additional Information - Cabinet Mounting & Signage

Cabinet Installation:

This panel is UL Listed as a Portable Cabinet Luminaire. It is suitable for inside and under cabinet mounting.

Option 1: Mirror Clip Mounting

3/8" Mirror Clips are included with each panel. Mirror clips should be spaced 12" (305mm) apart to ensure secure mounting. See fig. #6.

Option 2: Screw Mounting

3/4" (19mm) Screws are provided for screw mounting through panel. Screw holes should be drilled 1" (25mm) from edge of panel to avoid any LED circuit boards. See fig.#6.

NOTE: Mirror clips and screws will cause minor blockage of light in/around the area they are used. This is unavoidable but will have very minimal effect on total light

Sign Installation:

This panel is UL Recognized as a sign component and listed in the SAM Manual. All other material that incorporates the panel to make a complete sign is supplied by installer. It is the installer's responsibility to obtain an overall safety listing for the sign.

NOTE: Please allow 1/8" (3.175mm) extra space to enable the Etch Panel to "float" when using within a frame. This will allow for possible expansion under certain environmental conditions. Failure to do so may result in damage to LEDs and/or to frame as well as bowing of panel.

IMPORTANT!

Clean the Etch Panels with non-abrasive cleaning agents, such as a window cleaner. Abrasive cleaners will scratch the acrylic surface causing unwanted illumination along the scratch lines.

Refrain from excessive straining or pulling of Starter Cord. If cord with metal clip becomes disengaged from the Etch Panel, push metal clip back in until it "clicks" (see fig. #7).

If any part of the Etch Panel's white backer panel is lifted or removed, it is extremely difficult to press back down evenly. If there is any unevenness of the backer panel, this may create shadows and 'dull spots' in the light.

NOTE: Any alterations of this product voids the warranty! Please contact Tresco before any alterations are attempted.

Accessories: 'Link D' Extension Cords (P/N: L-LED-LINKD-x-1) available in lengths of 3", 6", 10", 12", 24", 48", 72" and 96" (8cm, 15cm, 25cm, 30cm, 60cm, 120cm, 180cm and 245cm). Tresco[®] offers other accessories including Switches and Dimmers. Check our catalog for more details.

IMPORTANT SAFETY INSTRUCTIONS

CAUTION: To reduce the risk of fire, electric shock, or injury to persons:

- NOT intended for outdoor use or where exposed to excessive moisture.
- NOT intended for use in enclosed or recessed installations, such as ceilings, soffits, walls or floors.
- Use only insulated staples or plastic ties to secure ALL cords.
- Route and secure cords so that they will not be pinched or damaged when the sign or other structure is pushed to the wall.
- Do not run line voltage power supply cord through holes in walls, ceilings, floors or similar permanent structure.
- If required, a licensed electrician should be consulted for wiring through permanent structures. When mounting and wiring light system, follow all local electric codes and the National Electrical Code (NEC).
- Disconnect electrical power before modifying system.
- Individual LEDs cannot be replaced. Instead replace entire Etch Panel.

This light is intended to be used as a fixture on metal, wood, particle board or other structurally sound, heat-resistant surface. Also intended for use with indoor signage. Care should be taken during and after installation to avoid contact of light with wiring, cord, or any combustible material.

Save these instructions for future reference.
For technical assistance: 1-800-227-1171





Listed in SAM Manual



Tresco Lighting
by Rev-A-Shelf
12400 Earl Jones Way
Louisville, KY 40299
Tel: 800-227-1171
Fax: 502-491-2215
Email: cservice@trescolighting.com
Web: www.trescolighting.com

I-EPA-1017